

Universal bearing press set

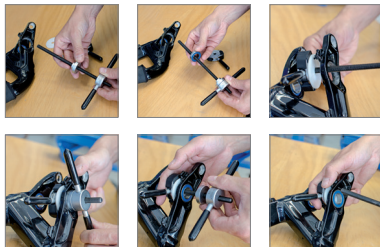

1721.1 (30x42 - BB30, 24x41 - BB86/92, 22x41, 10x26 - 6000, 10x22 - 6900, 12x28 - 6001, 12x24 - 6901, 15x28 - 6902, 15x24 - 6802, 15x26 - 1526, 17x28 - 17286, 17x30 - 6903, 17x26 - 6803, 20x32 - 6804, 25x37 - 6805, 9.5x22.2 (3/8"x7/8") - R6, 8x22 - 608, 29x42 - DUB), **1721.2** (Ø34, Ø50)