

SLO

1

S ključem 13 odvijemo matico krovno M8 (A) iz vzvoda ročaja. **POZOR** pri odvijanju, saj je vzmet stisnjena in lahko pri nepazljivem odvijanju izskoči.

2

Ročaj potisnemo proti čeljustim, ter s tem iz vodila vzvoda izvlečemo vzvod ročaja (B) in odstranimo vzmet (C). Matice in vzmeti za sistem z vijakom več ne potrebujemo.

3

Odvijemo imbus vijaka M4 (D) iz ročaja, ter odstranimo vzvod ročaja (E), ki ga tudi za sistem z vijakom ne bomo potrebovali.

4

Med pločevinasti del ročaja vstavimo nov vzvod ročaja (krajši) (F) in ga pritrdimo z dvema vijakoma imbus M4 (G) v ročaj.

5

Na vzvod ročaja privijemo novo matico nastavno M8 (H), nekako do polovice vzvoda.

6

Matico nastavno M8 (I) potisnemo skozi vodilo vzvoda, ter nanj pritrdimo novo matico samovarovalno M8 (J) s ključem 13, ob tem moramo z drugim ključem 13 pridržati matico nastavno M8. Matico samovarovalno M8 privijemo tako, da je med njo in vodilom vzvoda še malenkost zračnosti, da lahko matico nastavno nato z roko privijamo in odvijamo.

Unior d.d.
Kovaška cesta 10
3214 Zreče, Slovenia
T: +386 3 757 81 00
bike@unior.com
www.uniorbiketools.com

90837215



1693.12

EN

Adjustable screw for
clamp 1693.1 and
1693.1S

SLO

Set elementov za glavo
1693.1 in 1693.1S

 **UNIOR**[®]
BIKE TOOLS

uniorbiketools.com

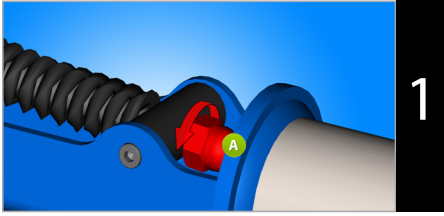

1

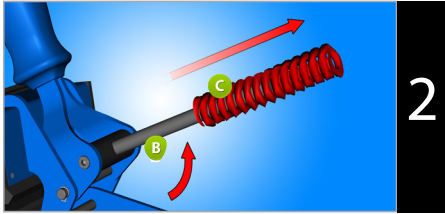

2

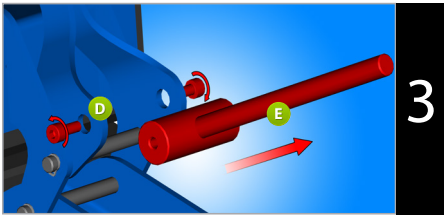

3

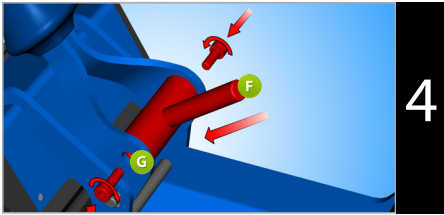

4

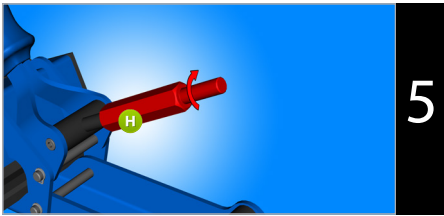

5

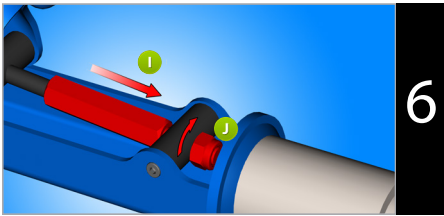

6

1 With a wrench unscrew the nut M8 (A) from the lever handle. **ATTENTION** while unscrewing: Spring is compressed and may pop out.

2 Push the handle towards the jaw and pull out the lever handle (B) from the guide lever, then remove the spring (C).

3 Unscrew the screws M4 (D) from the handle and remove the lever handle (E) which will not be required for the system with the screw.

4 Insert new lever handle (shorter) (F) between the metal part of the handle and fasten it on the handle with two screws M4 (G).

5 Screw new setting nut M8 (H) for about half of the lever on the lever handle.

6 Push the setting nut M8 (I) through the guide lever and with wrench 13 attach a new hex M8. While detain the nut wrench M8 (J) with other 13 wrench. Screw hex nut M8 so that there is a little gap between it and guide lever and that it is possible to screw or unscrew the nut.